

R/A RECEPTACLE MALE
PRINTED CIRCUIT

R197.160.D21

Series : **SMB**
CARLOCK

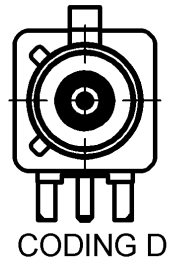
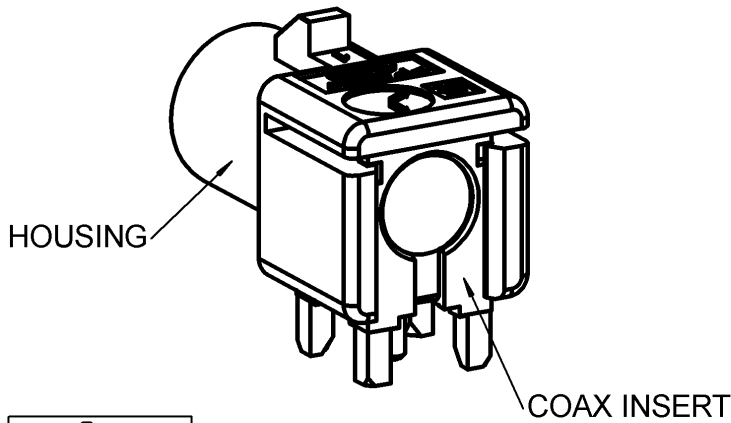
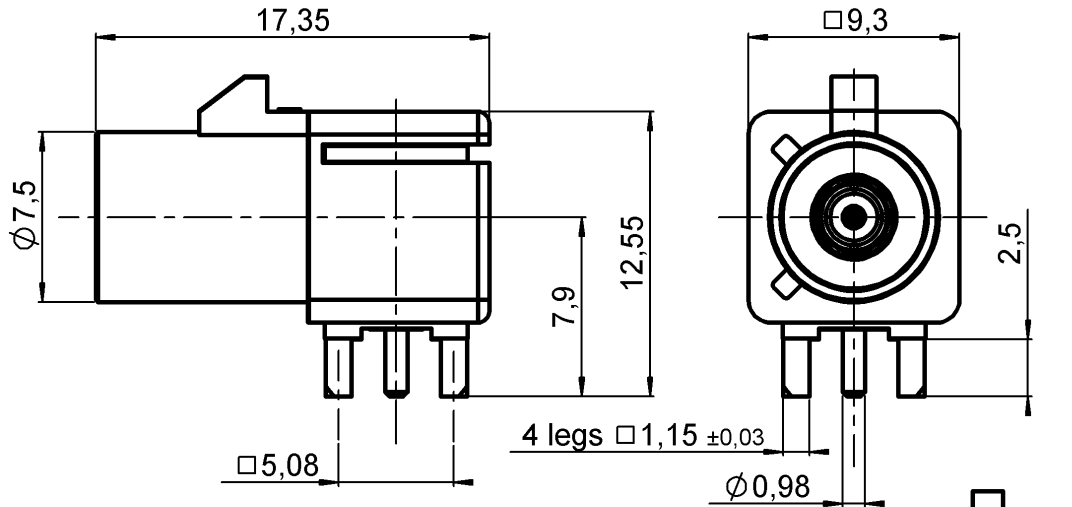

PANEL CUT OUT

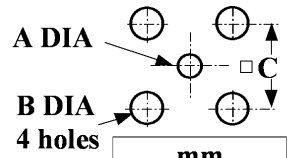

	mm	
	Maxi	mini
A	1.4	1.3
B	1.8	1.7
C	5.16	5

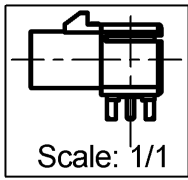

All dimensions are in mm.

COMPONENTS	MATERIALS	PLATINGS
BODY	BRASS	(μm)
CENTER CONTACT	BRASS	TIN 3 OVER NICKEL 2
OUTER CONTACT	-	GOLD 0.5 OVER NICKEL 2
INSULATOR	-	-
GASKET	PTFE	-
OTHERS PARTS	BRASS	NICKEL 2
- OTHERS PARTS	BRASS	- UL CLASSIFICATION : UL 94 V-2
HOUSING	PA6.6 30% GF (POLYAMIDE)	COLOR : BEIGE RAL 1001
-	-	-

Issue : 0617 B
In the effort to improve our products, we reserve the right to make changes judged to be necessary.



R/A RECEPTACLE MALE

R197.160.D21

PRINTED CIRCUIT

Series : **SMB**
CARLOCK

PACKAGING

SPECIFICATION

Standard	Unit	Other
100	'W' option	Contact us

QS9000

ELECTRICAL CHARACTERISTICS

ENVIRONMENTAL

Impedance	50	Ω
Frequency	0-4	GHz
VSWR	1.16 + 0,0000	x F(GHz) Maxi
Insertion loss	0.25	$\sqrt{F(GHz)}$ dB Maxi
RF leakage	- (- F(GHz)) dB Maxi
Voltage rating	335	Veff Maxi
Dielectric withstanding voltage	1000	Veff mini
Insulation resistance	1000	M Ω mini

Operating temperature	-40/+110	$^{\circ}$ C
Hermetic seal	NA	Atm.cm3/s
Panel leakage	NA	

OTHERS CHARACTERISTICS

Assembly instruction

Others :

* Coaxial Transmission Line Only

** Abrasion of the Tin Lead plating after 10 cycles but electrical continuity is guaranteed by the Nickel underplate.

MECHANICAL CHARACTERISTICS

Center contact retention		
Axial force – Mating end	10	N mini
Axial force – Opposite end	10	N mini
Torque	NA	N.cm mini

Recommended torque		
Mating	NA	N.cm
Panel nut	NA	N.cm

Mating life	100	** Cycles mini
Weight	3,1000	g

Issue : 0617 B

In the effort to improve our products, we reserve the right to make changes judged to be necessary.

